

# Kit 1431

SUBARU Tribeca, 5-dr SUV, 06-

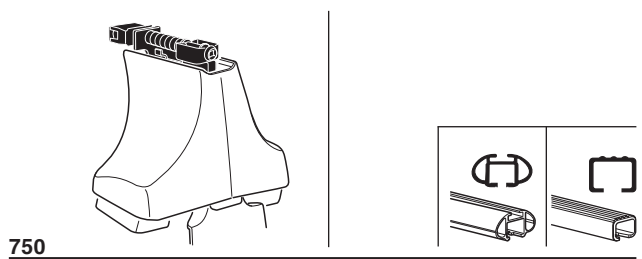

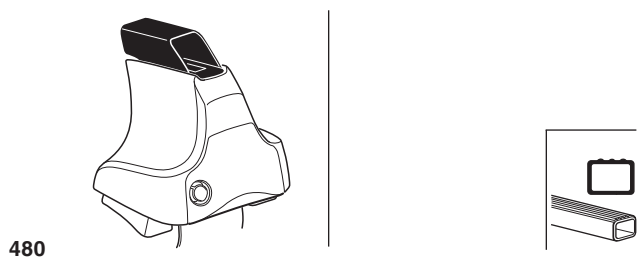

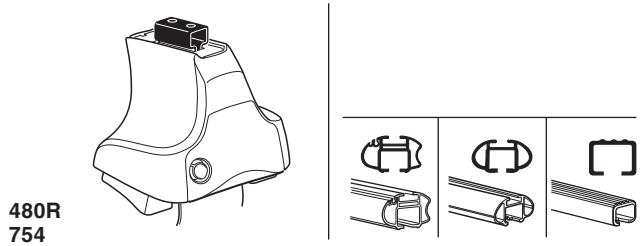
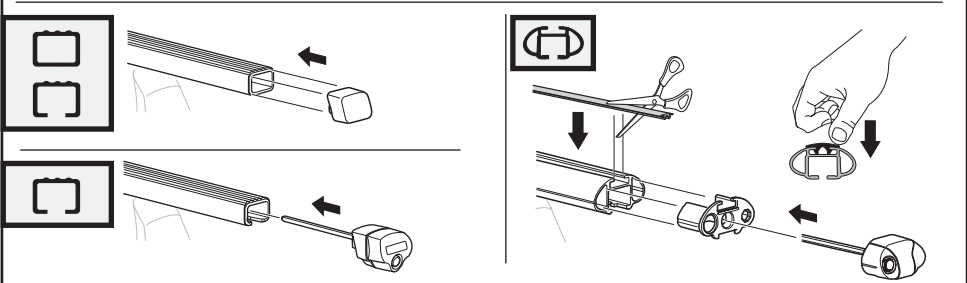
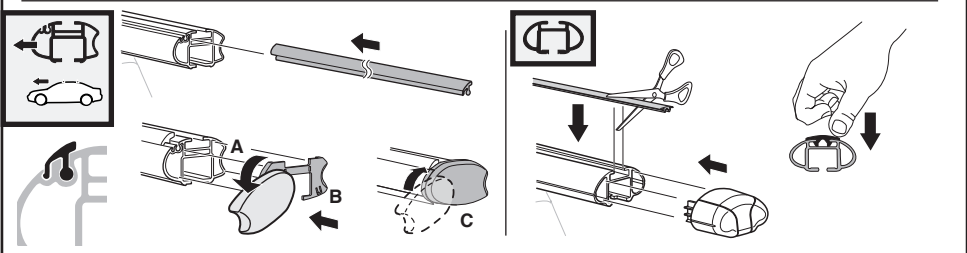
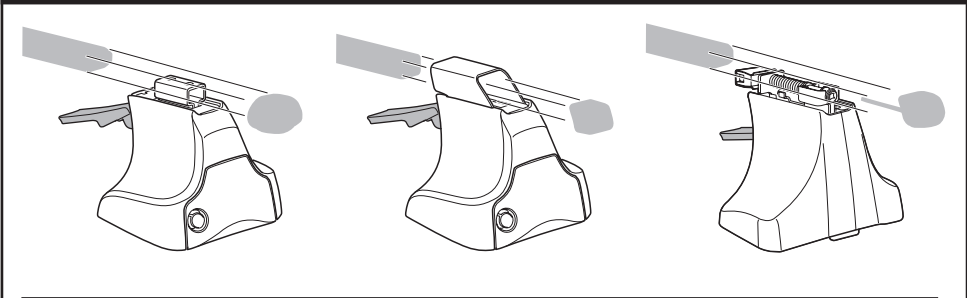
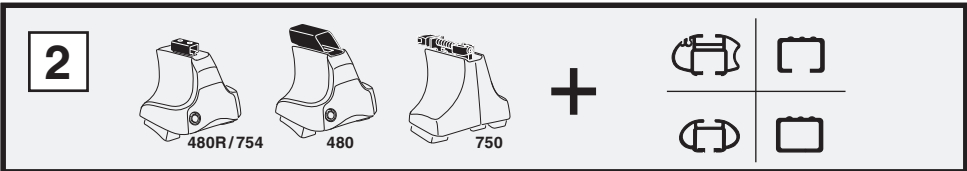
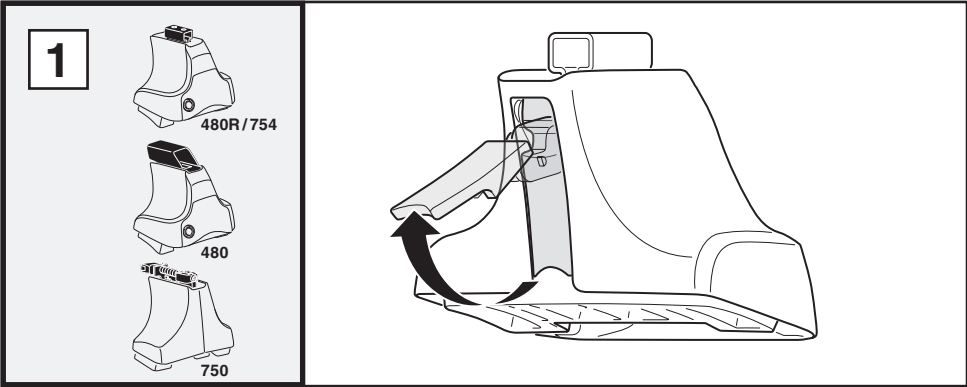

**3**

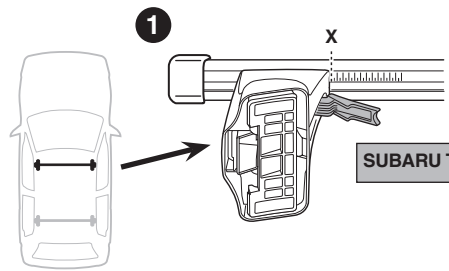
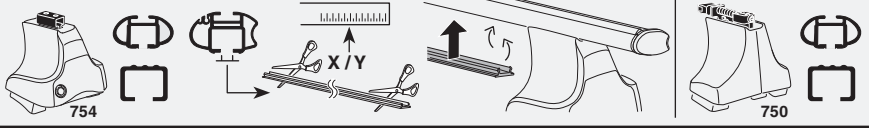

	X
SUBARU Tribeca, 5-dr SUV, 06-	52,5

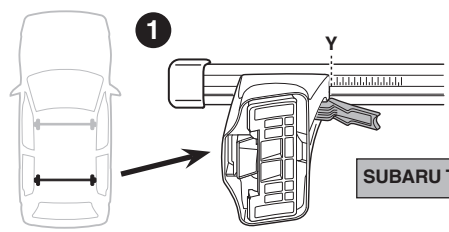
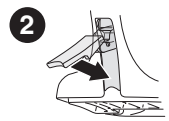

	Y
SUBARU Tribeca, 5-dr SUV, 06-	47

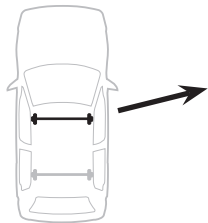
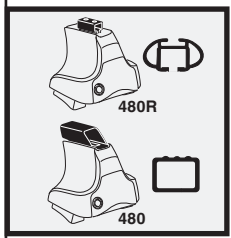
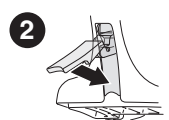

	X inch	X mm
SUBARU Tribeca, 5-dr SUV, 06-	46 1/4"	1176 mm

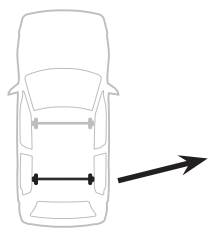
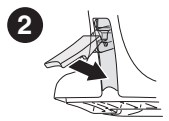
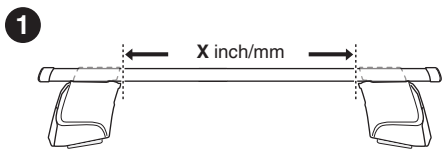

	Y inch	Y mm
SUBARU Tribeca, 5-dr SUV, 06-	44 1/8"	1121 mm

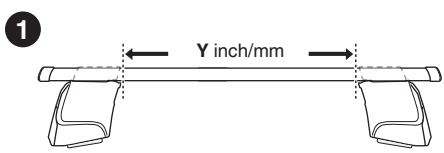

# 4

SUBARU Tribeca, 5-dr SUV, 06-

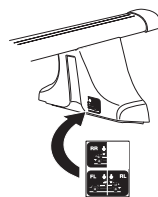
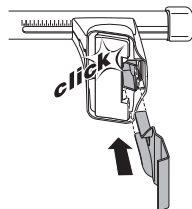
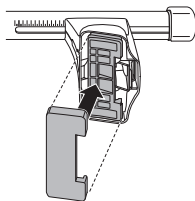
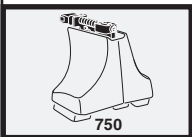
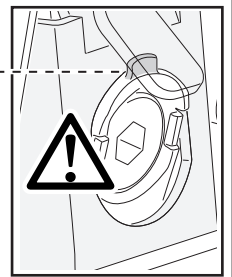
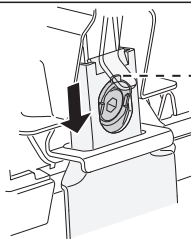
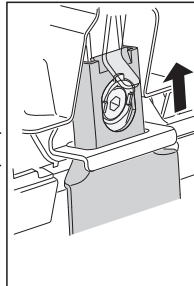
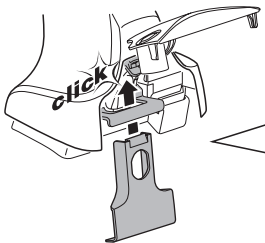
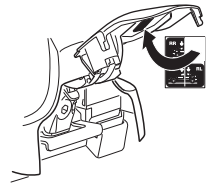
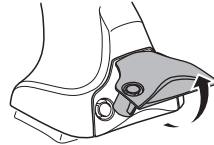
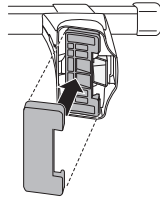
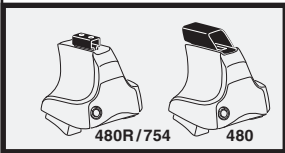
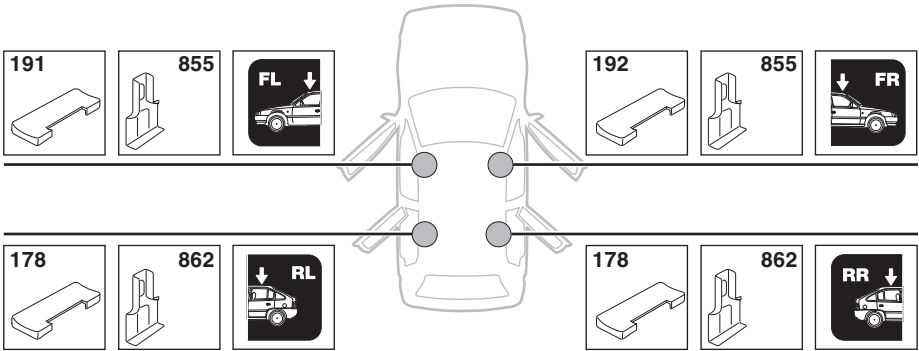

5

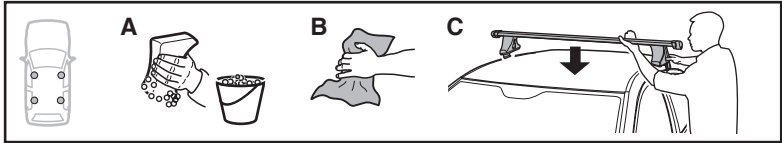

	X mm	Y mm	X inch	Y inch
SUBARU Tribeca, 5-dr SUV, 06-	300 mm	750 mm	11 3/4"	29 1/2"

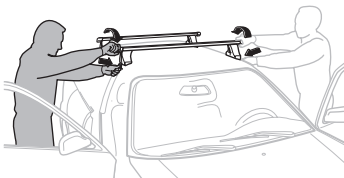
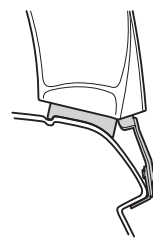
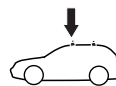
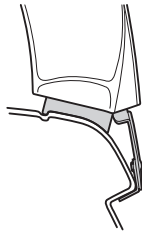
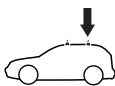
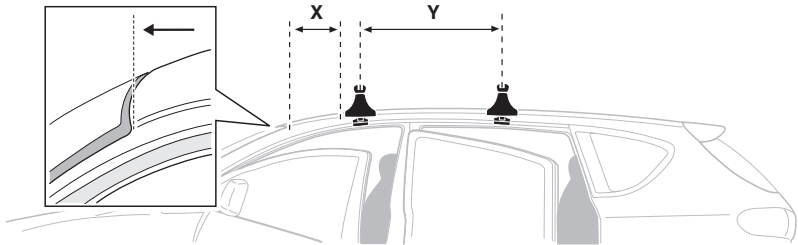

**GB/US** Tighten alternately

**D** Die Schrauben abwechselnd anziehen

**F** Serrer alternativement chaque côté

**NL** Afwisselend aan de linker- en de rechterkant aandraaien

**I** Alternare il serraggio delle viti

**E** Serrare alternativamente

**PT** Aperte alternadamente

**S** Dra åt växelvis

**FIN** Kierrä vuorotellen

**EST** Pinguldage vaheldumisi

**LAT** Pielveciēt pamīšus

**LIT** Užsukinėkite pakaitomis

**PL** Śruby dokręcaj naprzemiennie

**RU** Затягивайте попеременно

**CZ** Pokręťte багаžníka dokręcaj dokręcaj naprzemiennie.

**SK** Dotahujte striedavo

**SLO** Privijajte izmenično.

**HR** Naizmjenično zategnite

**HU** Egymástól függetlenül szorítandó

**GR** Σφιγγετε εναλλάξ

**TR** Dönüşümlü sıkın

**中文** 交替拧紧

**한국어** 번갈아 가며 조이십시오.

**日本語** 交互に締め付けてください。

**ไทย** ชั้้นในแบบสลับ

6



480R/754



480

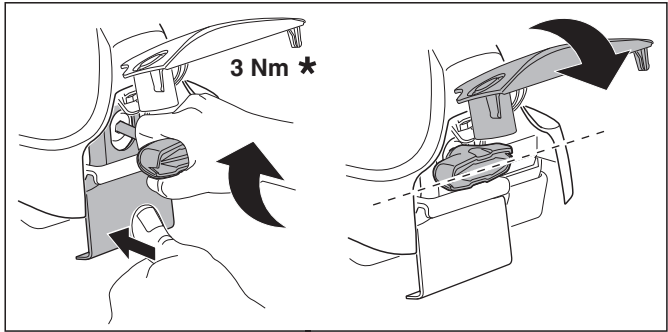
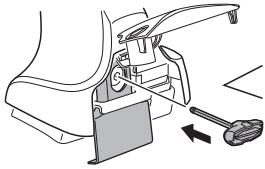

3 Nm \*

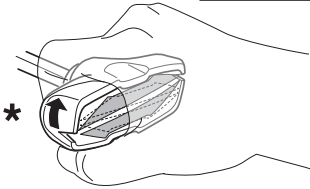

\*

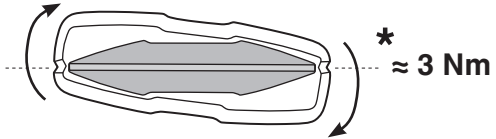

\* ≈ 3 Nm

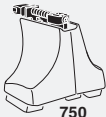

750

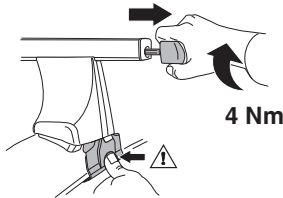

4 Nm

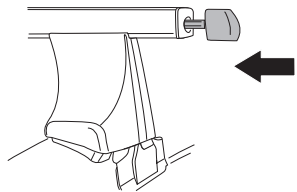

i



1



2

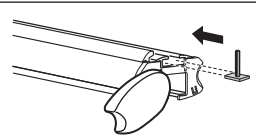

i

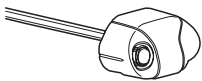

1

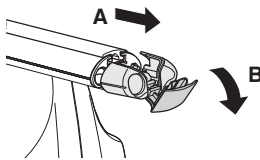

2

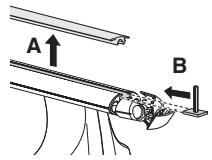

i



1

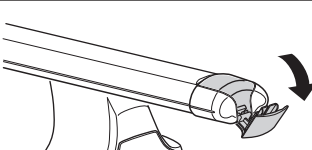

2

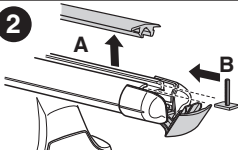

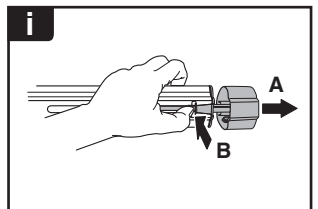
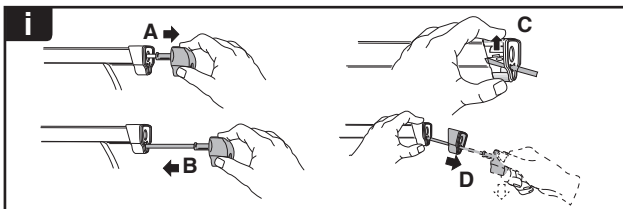
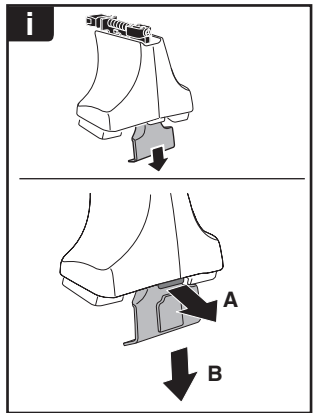
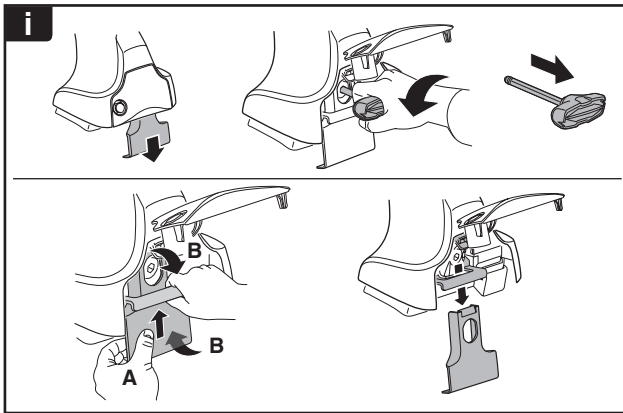
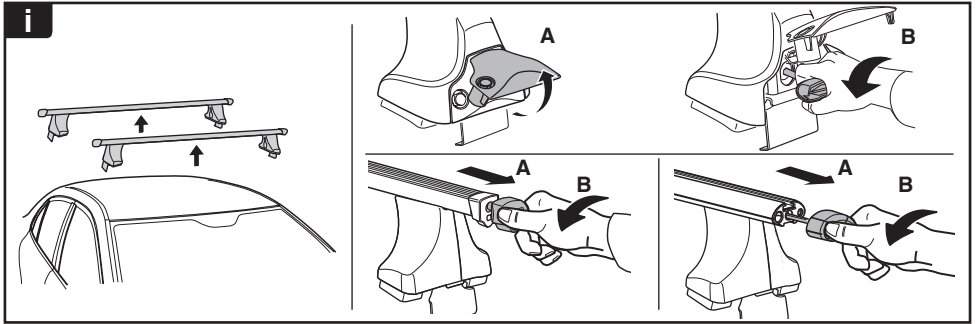

**THULE**  
SWEDEN  
**ONE  
KEY  
SYSTEM**

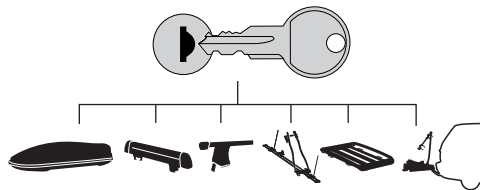

- 544 (x4)
- 596 (x6)
- 588 (x8)
- NA 510 (x10)
- EUR 452 (x12)
- ASIA

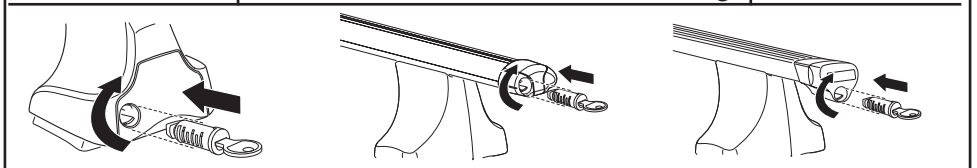

WW ▶ Thule Sweden AB, Box 69, 330 33 Hillerstorp, SWEDEN  
NA ▶ Thule Inc., 42 Silvermine Road, Seymour, Connecticut 06483, USA

info@thule.com  
customer.service@thule.com

www.thule.com