

Kit 1341

VOLVO S40, 4-dr Sedan, 04- / *05-

*North America

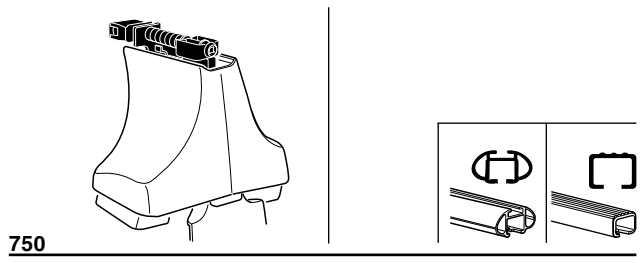

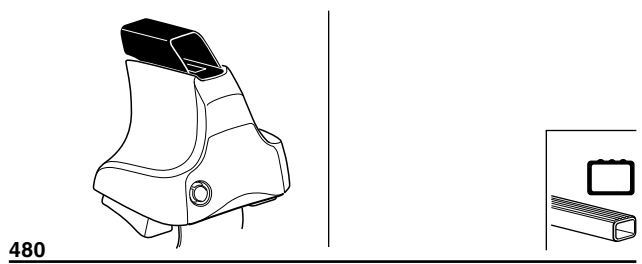
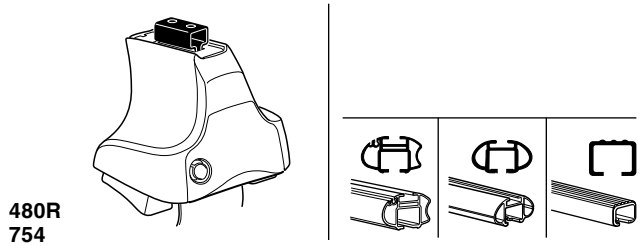
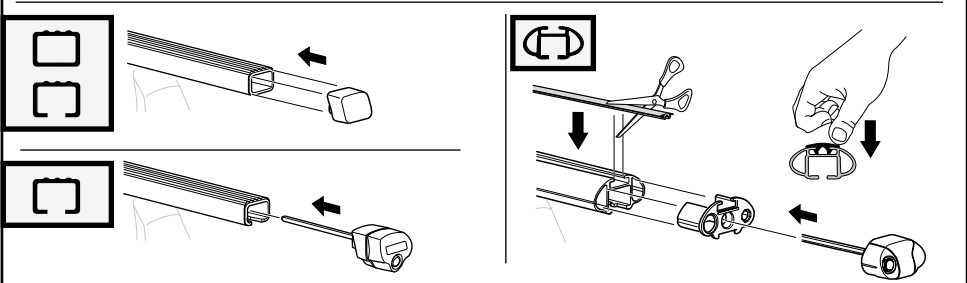
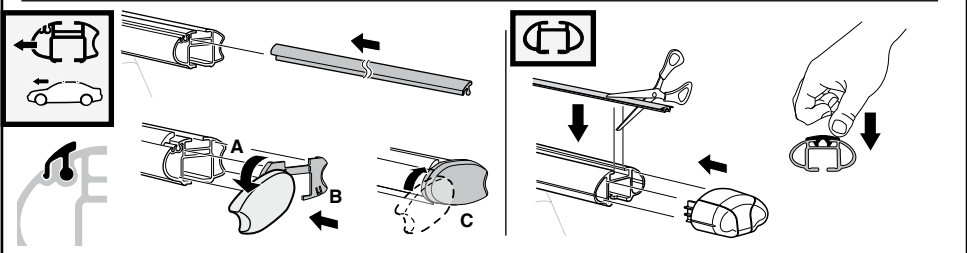
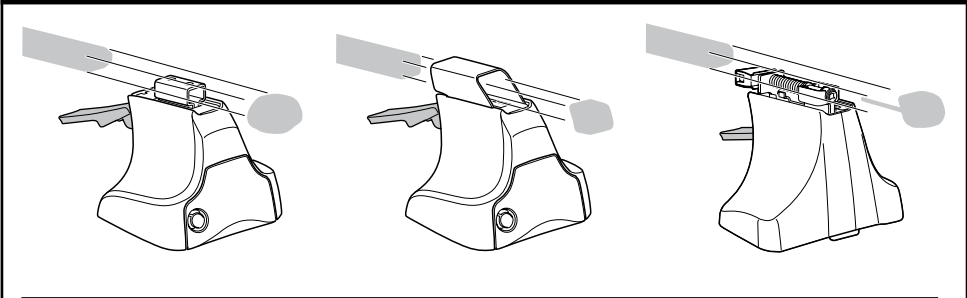
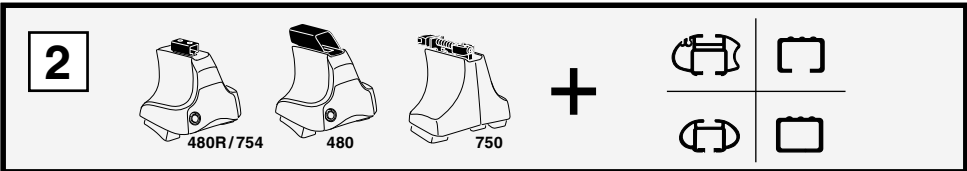
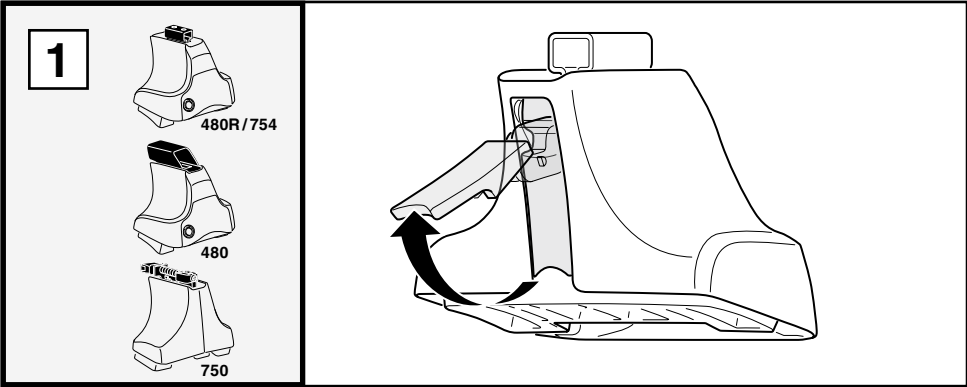

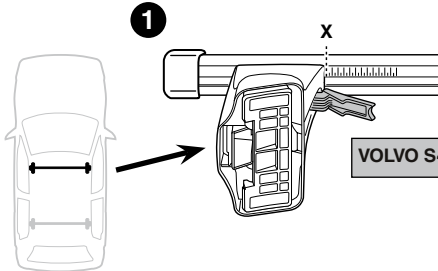
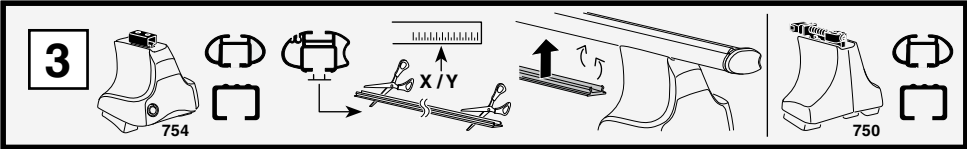

	X
VOLVO S40, 4-dr Sedan, 04- / *05-	41,5

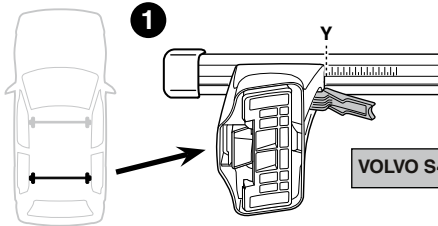
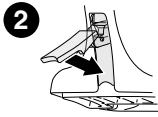

	Y
VOLVO S40, 4-dr Sedan, 04- / *05-	39,5

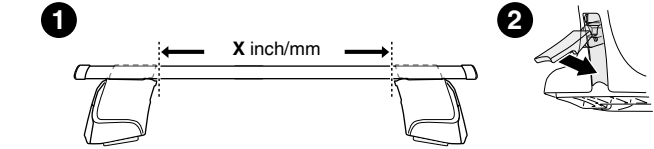
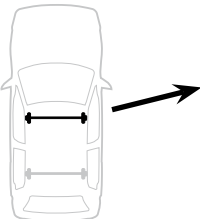
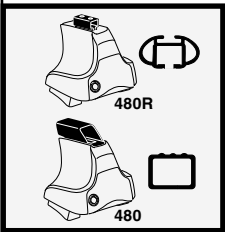
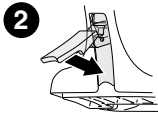

	X inch	X mm
VOLVO S40, 4-dr Sedan, 04- / *05-	42"	1066 mm

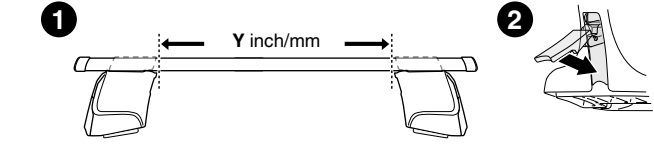
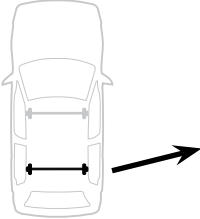

	Y inch	Y mm
VOLVO S40, 4-dr Sedan, 04- / *05-	41 1/8"	1046 mm

4

VOLVO S40, 4-dr Sedan, 04- / *05-

164



629



FL



163



630



FR



163



631



RL



164



632



RR



480R/754



480

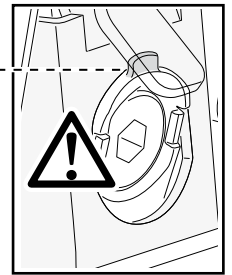
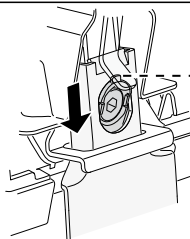
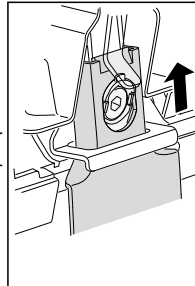
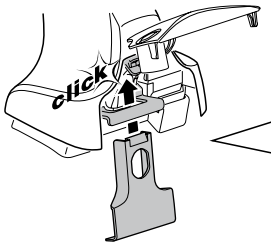
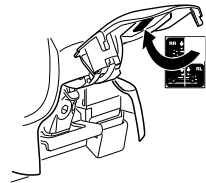
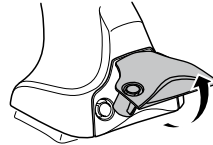
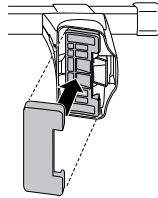

750

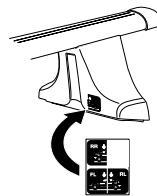
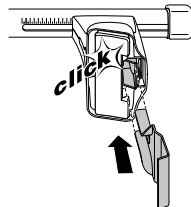
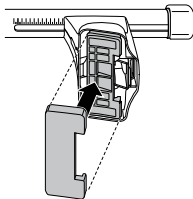

5

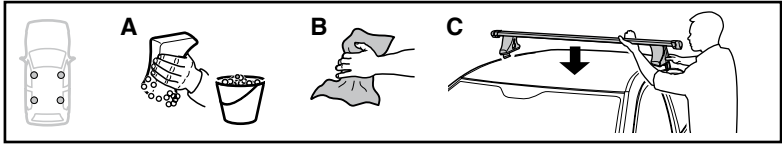

	X mm	Y mm	X inch	Y inch
VOLVO S40, 4-dr Sedan, 04- / *05-	225 mm	830 mm	8 7/8"	32 5/8"

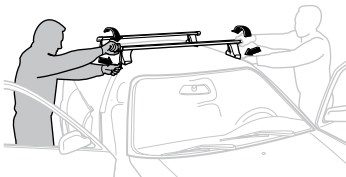
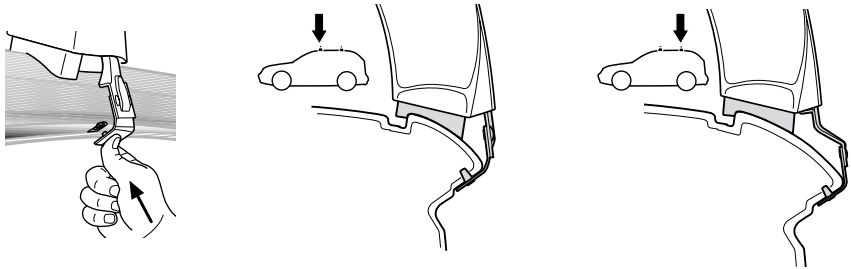
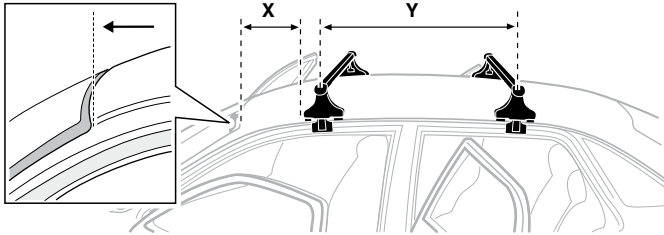

GB/US Tighten alternately

D Die Schrauben abwechselnd anziehen

F Serrer alternativement chaque côté

NL Afwisselend aan de linker- en de rechterkant aandraaien

I Alternare il serraggio delle viti

E Serrare alternativamente

PT Aperte alternadamente

S Dra åt växelvis

FIN Kierrä vuorotellen

EST Pinguldage vaheldumisi

LAT Pievelciēt pamišus

LIT Užsukinėkite pakaitomis

PL Śruby dokręcaj naprzemiennie

RU Затягивайте попеременно

CZ Pokręťta bāgažnīka dokręcaj dokręcaj naprzemiennie.

SK Doťahujte striedavo

SLO Privijajte izmenično.

HR Naizmjenično zategnite

HU Egymástól függetlenül szorítandó

GR Σφιγγετε εναλλάξ

TR Dönüşümlü sıkın

中文 交替拧紧

한국어 번갈아 가며 조이십시오.

日本語 交互に締め付けてください。

ไทย ขันในแบบสลับ

6

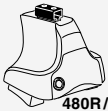

480R/754



480

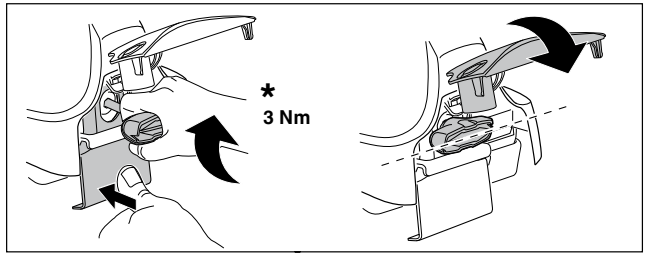
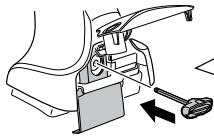

*
3 Nm

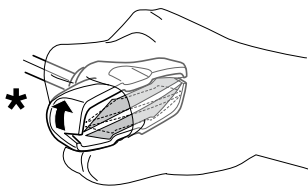

*

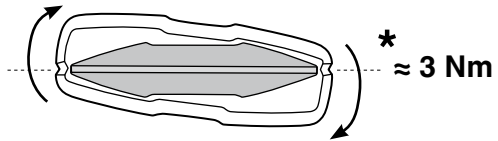

*
≈ 3 Nm

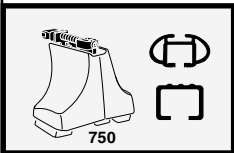
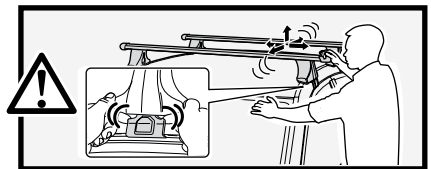

750

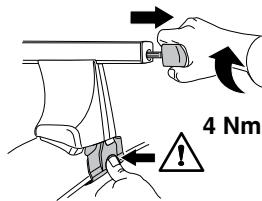

4 Nm

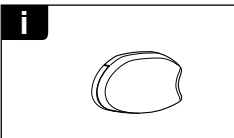
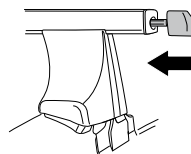

i

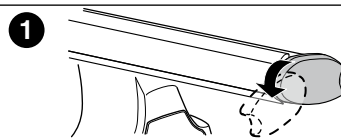

1

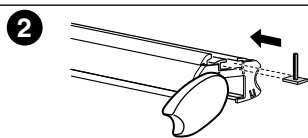

2

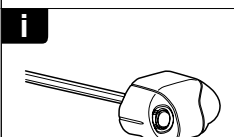

i

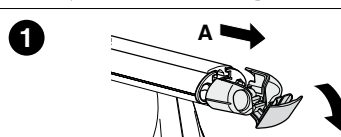

1

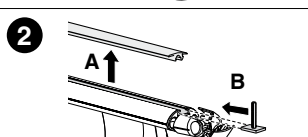

2

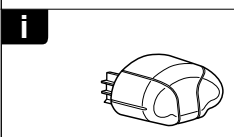

i

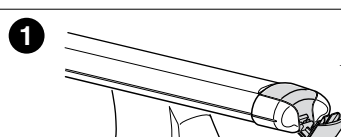

1

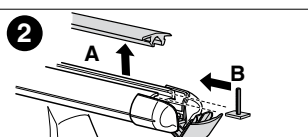

2

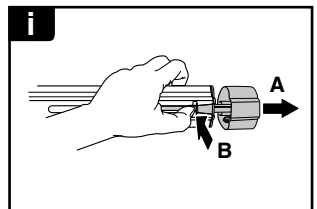
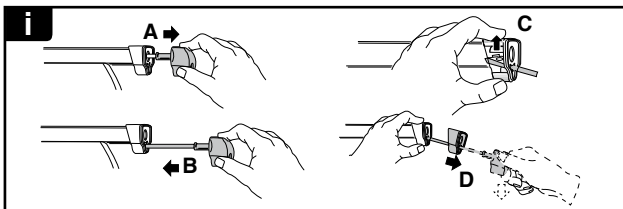
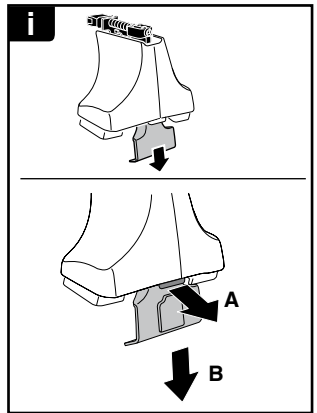
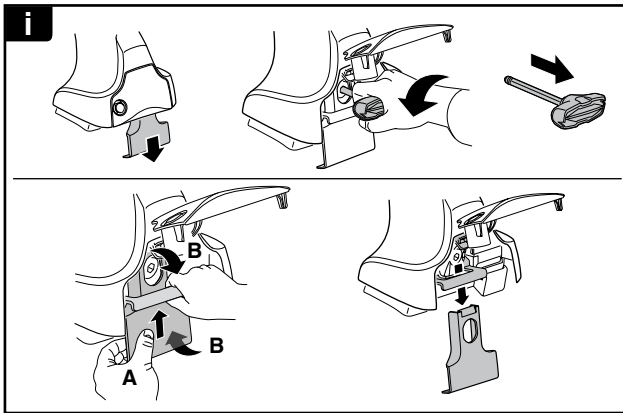
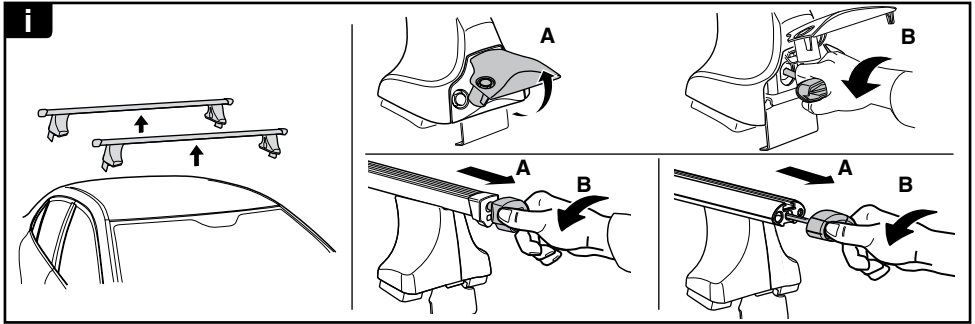

THULE
SWEDEN
**ONE
KEY
SYSTEM**

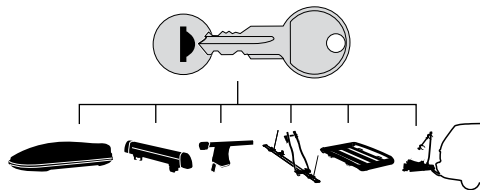

- 544 (x4)
- 596 (x6)
- 588 (x8)
- NA 510 (x10)
- EUR 452 (x12)
- ASIA

