

HYUNDAI H-1, 5-dr Van, 08 – (With dual sliding doors)
HYUNDAI iLoad, 5-dr Van, 08 – (With dual sliding doors), (Asia)
HYUNDAI iMax, 5-dr Bus, 08 – (With dual sliding doors), (Asia)
HYUNDAI Starex, 5-dr Van, 08 – (With dual sliding doors)

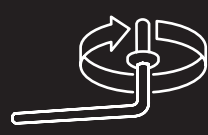

Load Carrier Kit 1469

121469

THULE

SWEDEN

PROFESSIONAL

120,6 cm	HUYNDAI H-1, 5-dr Van, 08- (With dual sliding doors)
120,6 cm	HUYNDAI Load, 5-dr Van, 08- (With dual sliding doors), (Asia)
120,6 cm	HUYNDAI Max, 5-dr Bus, 08- (With dual sliding doors), (Asia)
120,6 cm	HUYNDAI Starex, 5-dr Van, 08- (With dual sliding doors)

Y

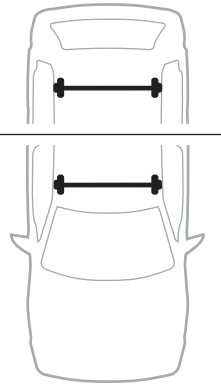
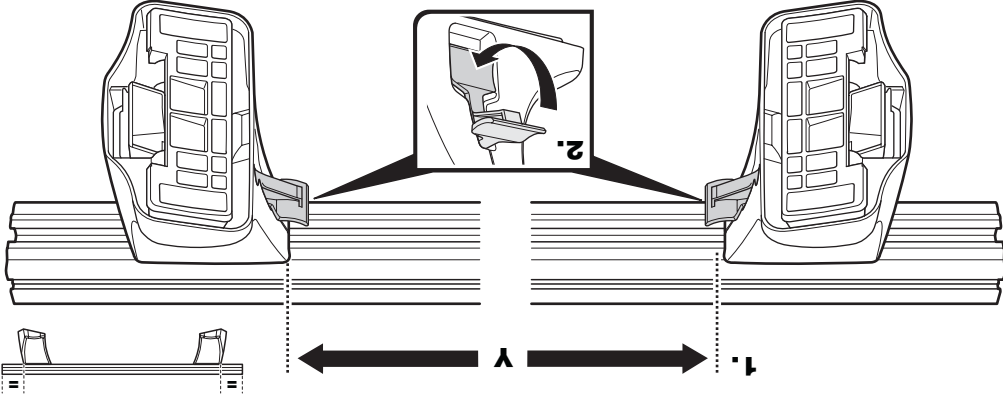

124,6 cm	HUYNDAI H-1, 5-dr Van, 08- (With dual sliding doors)
124,6 cm	HUYNDAI Load, 5-dr Van, 08- (With dual sliding doors), (Asia)
124,6 cm	HUYNDAI Max, 5-dr Bus, 08- (With dual sliding doors), (Asia)
124,6 cm	HUYNDAI Starex, 5-dr Van, 08- (With dual sliding doors)

X

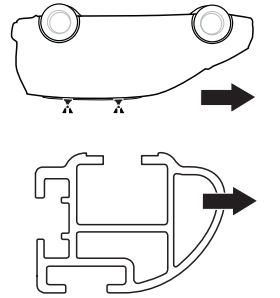
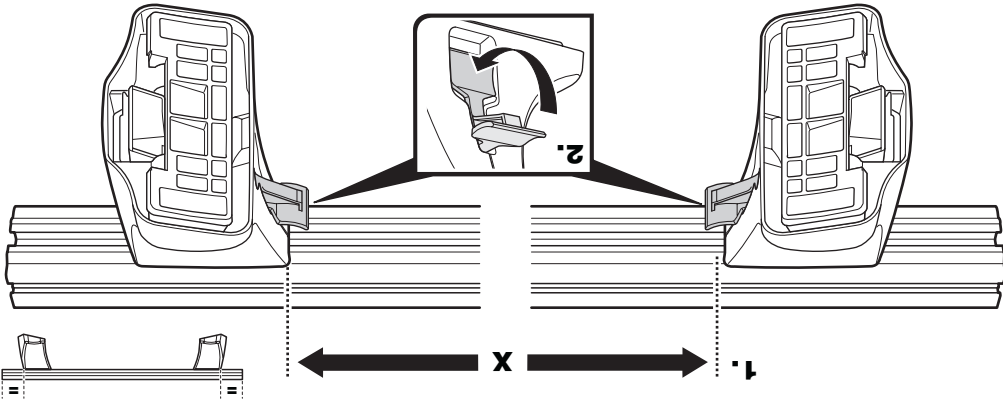

3

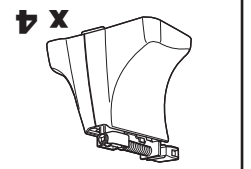
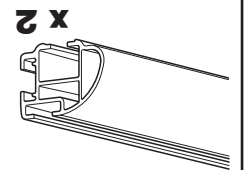
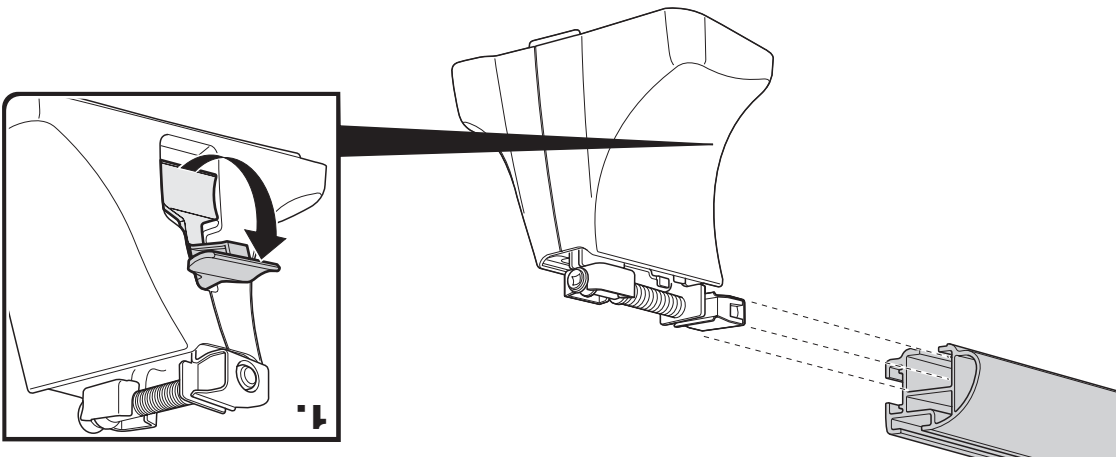

2

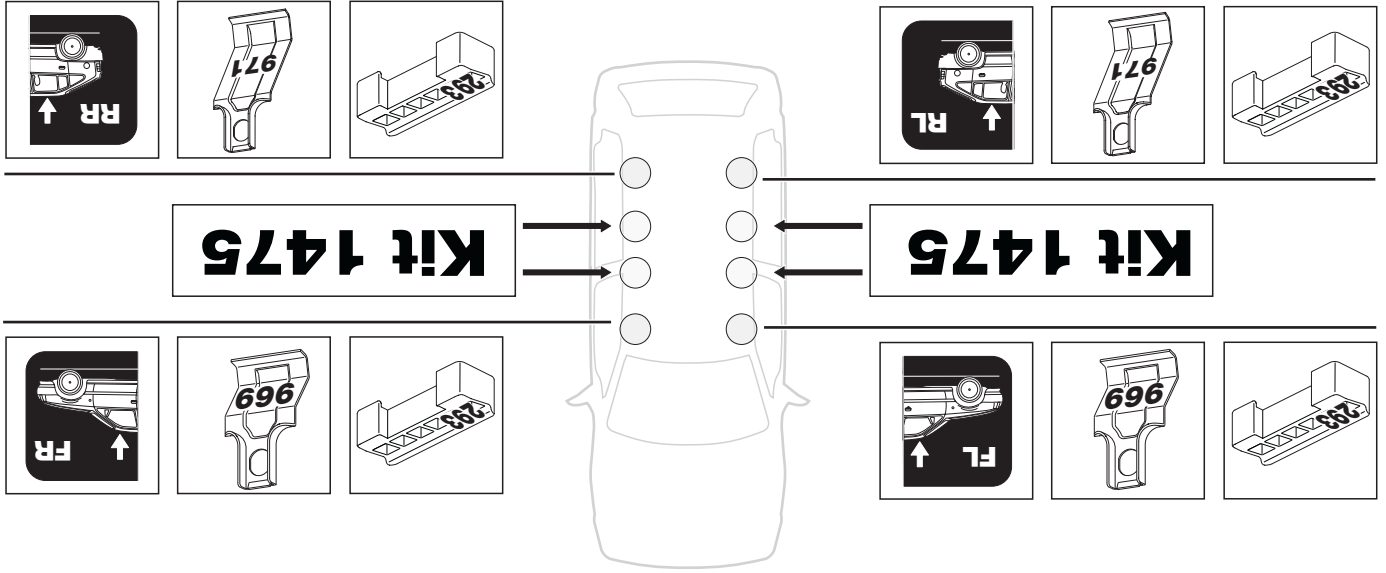

HYUNDAI H-1, 5-dr Van, 08 – (With dual sliding doors)
 HYUNDAI iLoad, 5-dr Van, 08 – (With dual sliding doors), (Asia)
 HYUNDAI iMax, 5-dr Bus, 08 – (With dual sliding doors), (Asia)
 HYUNDAI Starex, 5-dr Van, 08 – (With dual sliding doors)

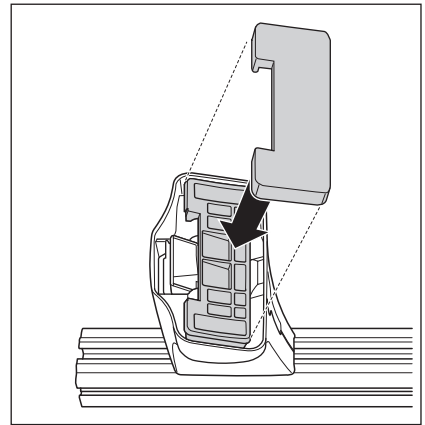
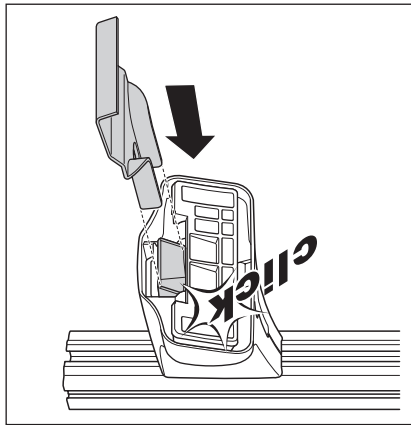
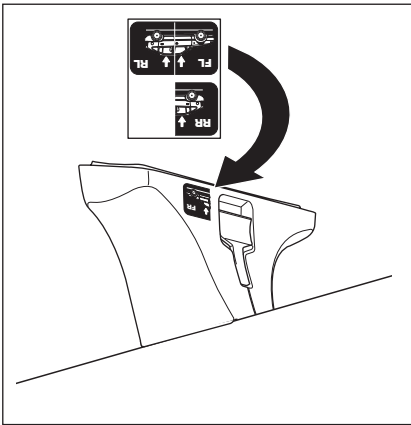

5

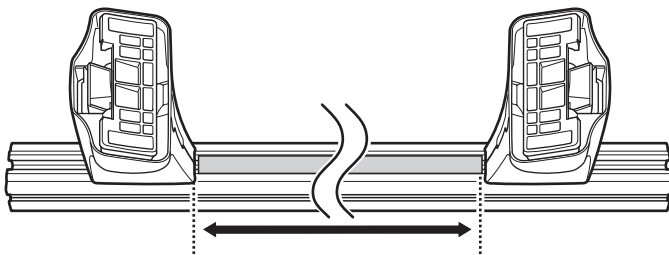
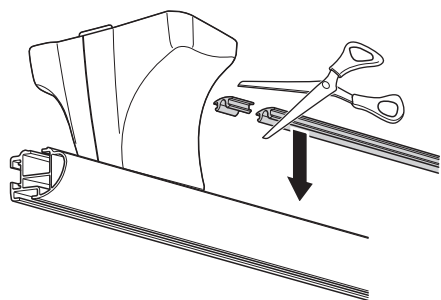

4

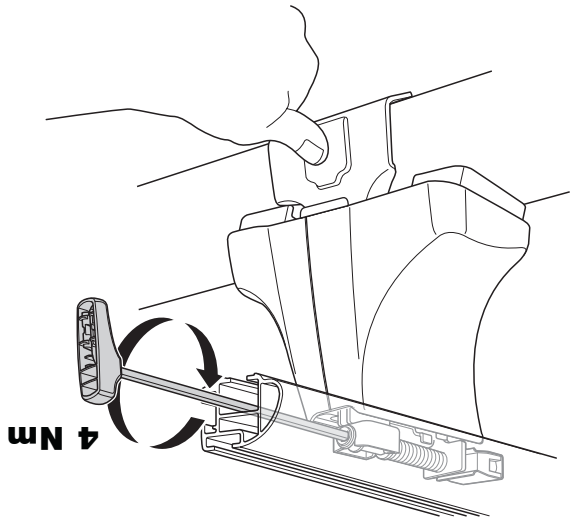
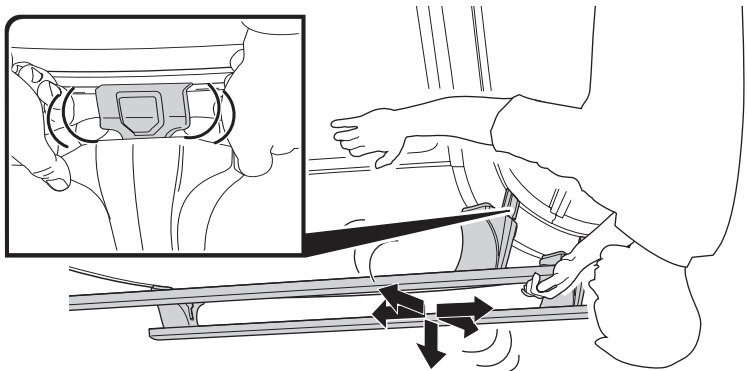

- GB** Tighten alternately
- D** Die Schrauben abwechselnd anziehen
- F** Serrer alternativement chaque côté
- NL** Afwisselend aan de linker- en de rechterkant aandraaien
- I** Serrare alternativamente
- E** Alternare il serraggio delle viti
- PT** Aperte alternadamente
- S** Dra åt växelvis
- FIN** Kierrä vuorotellen
- EST** Pinguldage vaheldumisi
- LAT** Pieviciet pamšus
- LIT** Užsukinėkite pakaitomis
- PL** Śruby dokręcaj naprzemiennie
- RU** Затягивайте попеременно
- CZ** Pokrétta bagazníka dokrécaj dokrécaj naprzemiennie.
- SK** Dotiahnuť striedavo
- SLO** Privijajte izmenično.
- HR** Naizmjenično zategnite
- HU** Egyarástól fűggetlenül szorítandó
- GR** Σφιγνέτε εναλλάξ
- TR** Dönüşümlü sıkın
- 中文** 交替拧紧
- 한국어** 번갈아가며 조이십시오.
- 日本語** 交互に締め付けてください。
- ไทย** สลับขันสกรู

1930 mm

380 mm

KIT 1475

HYUNDAI H-1, 5-dr Van, 08 – (With dual sliding doors)

HYUNDAI iLoad, 5-dr Van, 08 – (With dual sliding doors), (Asia)

HYUNDAI iMax, 5-dr Bus, 08 – (With dual sliding doors), (Asia)

HYUNDAI Starex, 5-dr Van, 08 – (With dual sliding doors)

6

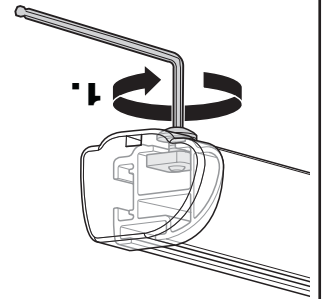
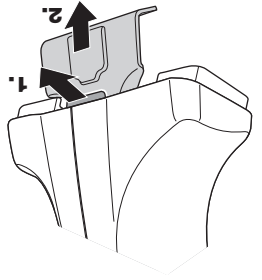

- GB** Removal
- D** Demontieren
- F** Démontage
- NL** Demontage
- I** Rimozione

- E** Desmontaje
- PT** Remoção
- S** Demontering
- FIN** Irrotus
- EST** Eemaldamine

- LAT** Noņemšana
- LIT** Nuėmimas
- PL** Wymontowanie
- RU** Чнятие
- CZ** Odmontování

- SK** Demontáž
- SLO** Odstranjevanje
- HR** Uklanjanje
- HU** Leszerelés
- GR** Αφαίρεση

- TR** Sökme
- 中文** 拆除
- 日本語** 取り外し
- 한국어** 분리
- ไทย** ถอดออก

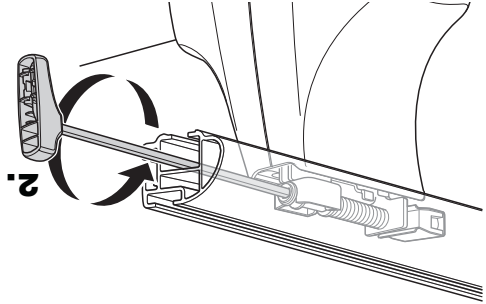
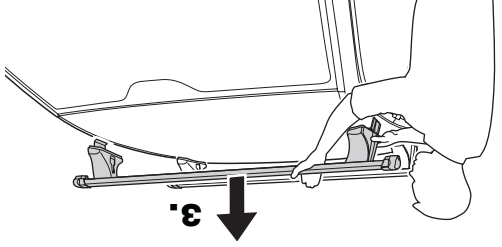

9

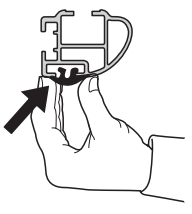
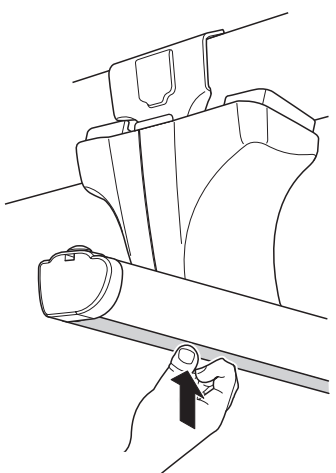
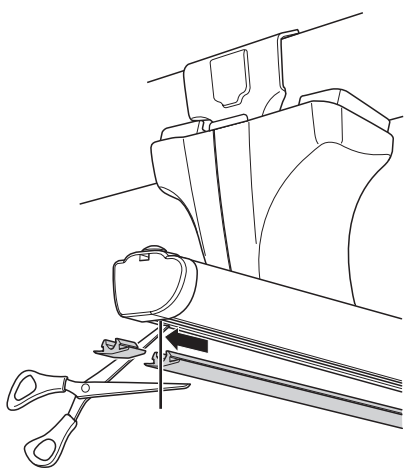
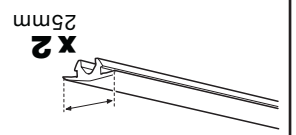

8

- X 1** 5mm L-shaped metal strip
- X 4** Screws
- X 4** Spacers
- X 2** Seat cover parts
- X 2** Seat cover parts

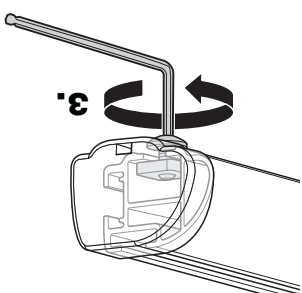
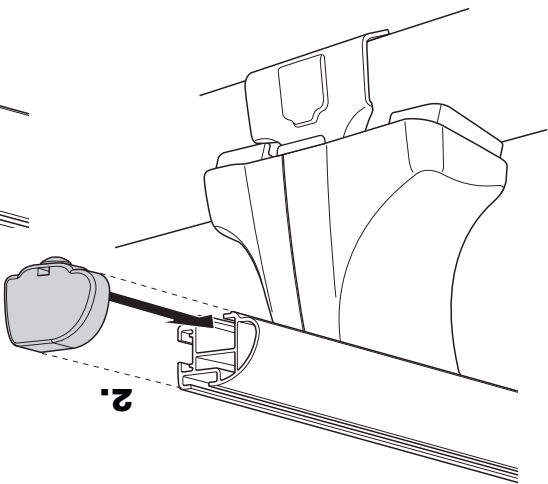
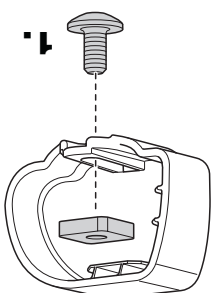

GB Removal
D Demontieren
F Démontage
NL Demontage
I Rimozione

E Desmontaje
PT Remoção
S Demonerung
FIN Irrotus
EST Eemaldamine

LAT Noņemšana
LIT Nuėmimas
PL Wymontowywanie
RU СНЯТИЕ
CZ Odmontování

SK Demontáž
SLO Odstranjevanje
HR Uklanjanje
HU Leszerelés
GR Αφαίρεση

TR Sökme
 中文 拆除
 日本語 取り外し
 한국어 분리
 ไทย การถอด

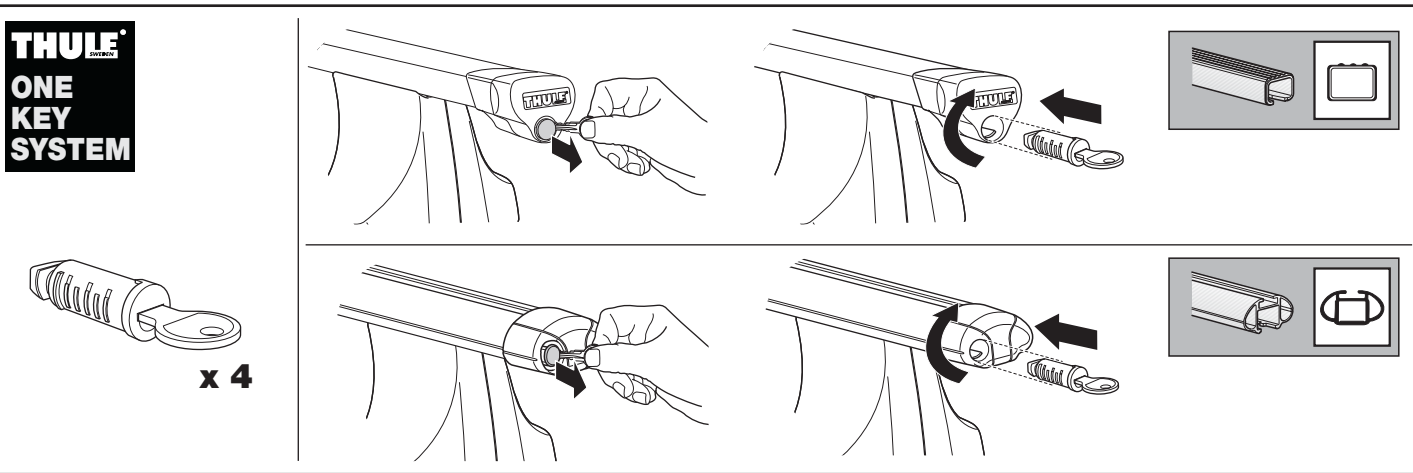
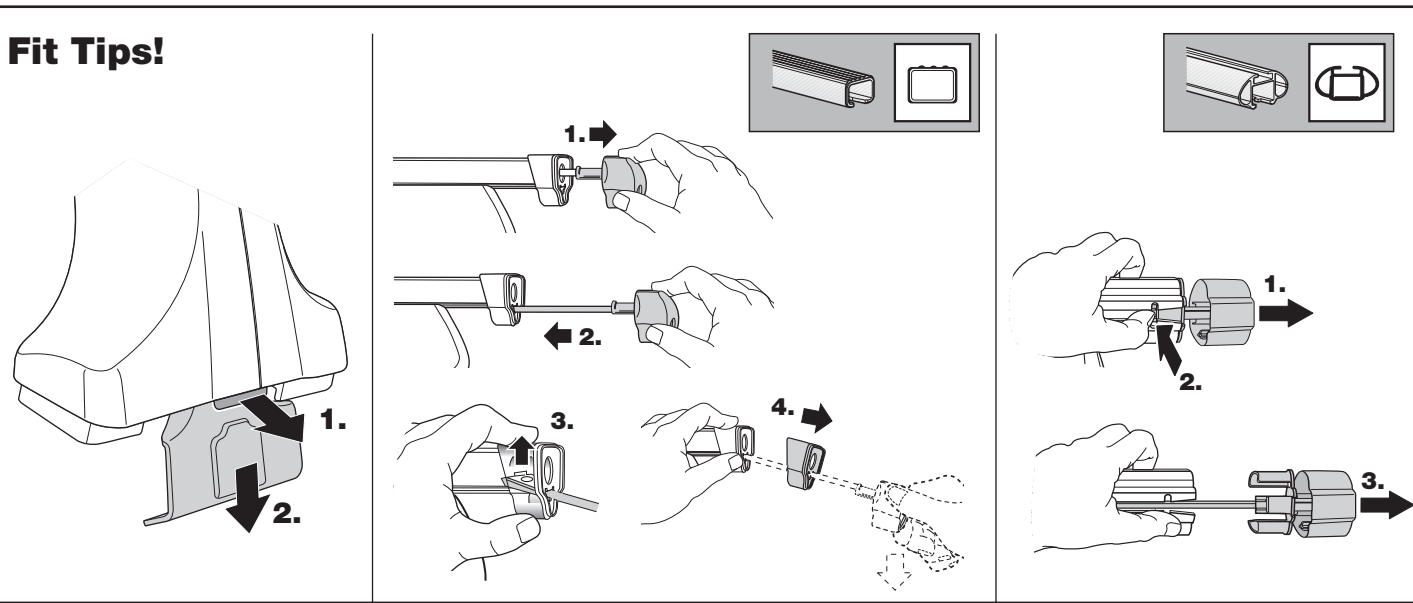
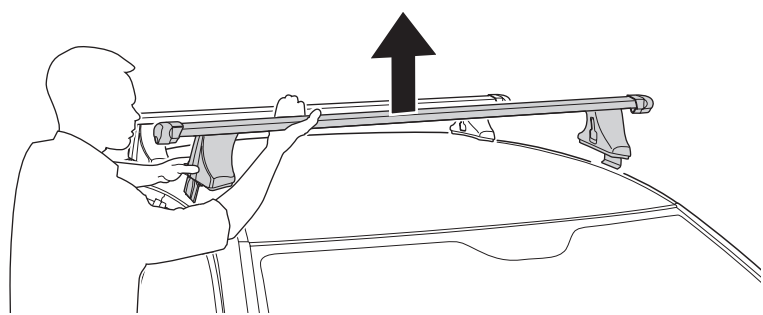
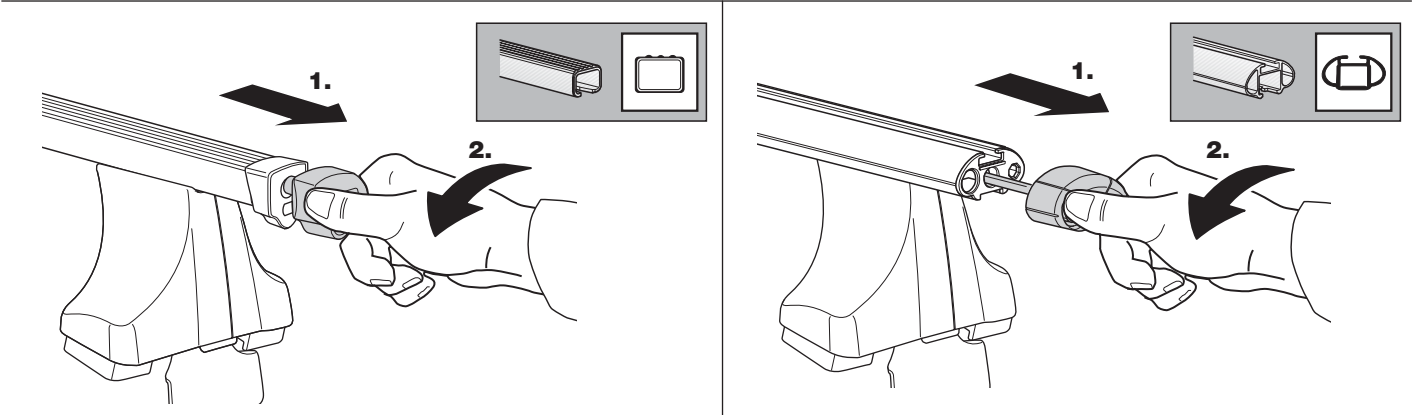

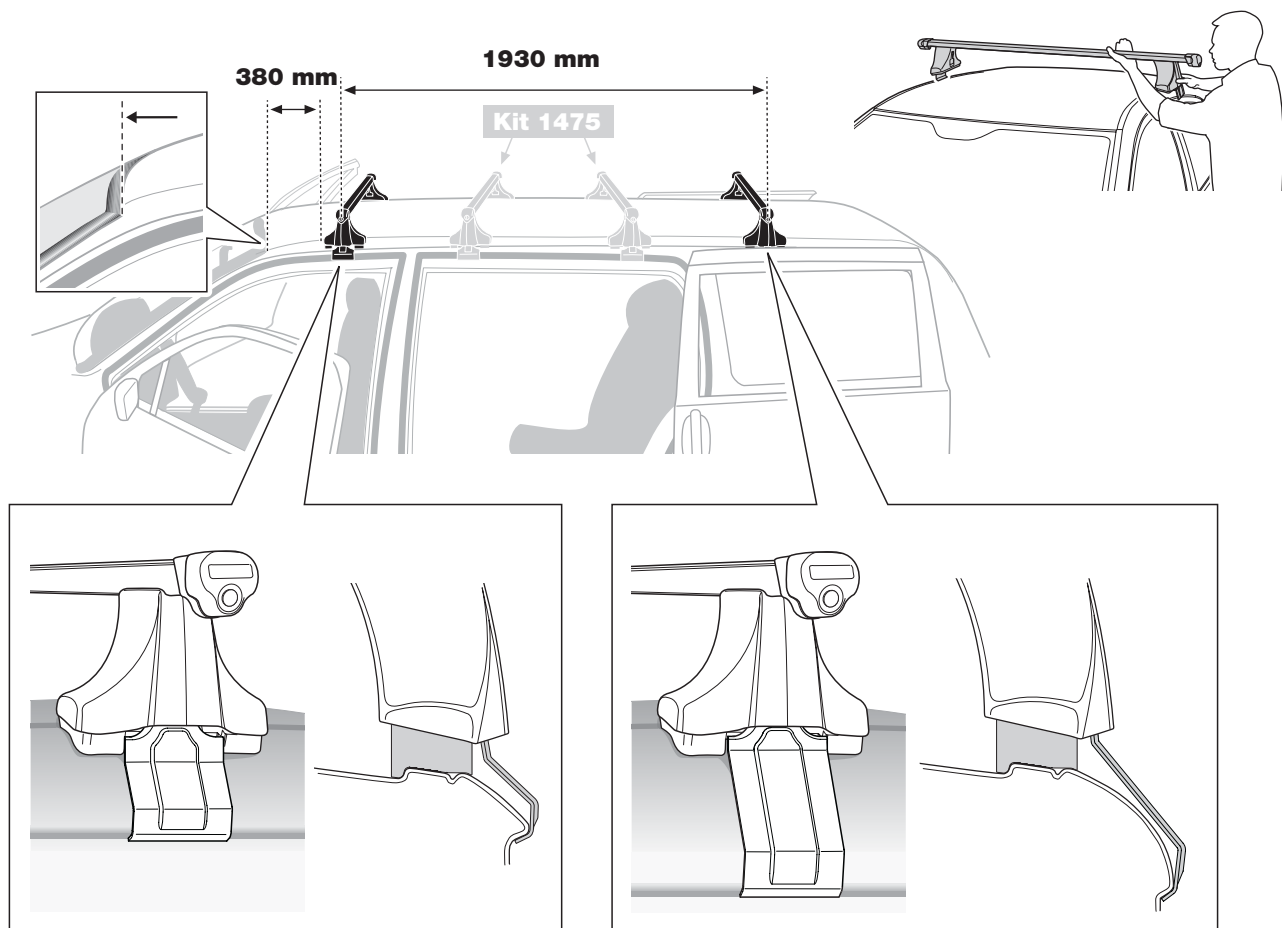
6**7**

- | | | | |
|------------|---|------------|---|
| GB | Tighten alternately | PL | Śruby dokręcaj naprzemiennie |
| D | Die Schrauben abwechselnd anziehen | RU | Затягивайте попеременно |
| F | Serrer alternativement chaque côté | CZ | Pokręťta bagażníka dokręcaj dokręcaj naprzemiennie. |
| NL | Afwisselend aan de linker- en de rechterkant aandraaien | SK | Dotahujte striedavo |
| I | Serrare alternativamente | SLO | Privijajte izmenično. |
| E | Alternare il serraggio delle viti | HR | Naizmjenično zategnite |
| PT | Aperte alternadamente | HU | Egymástól függetlenül szorítandó |
| S | Dra åt växelvis | GR | Σφίγγετε εναλλάξ |
| FIN | Kierrä vuorotellen | TR | Dönüşümlü sıkın |
| EST | Pinguldage vaheldumisi | 中文 | 交替拧紧 |
| LAT | Pievelciet pamišus | 한국어 | 번갈아 가며 조이십시오. |
| LIT | Užsukinėkite pakaitomis | 日本語 | 交互に締め付けてください。 |
| | | ไทย | ขันในแบบสลับ |

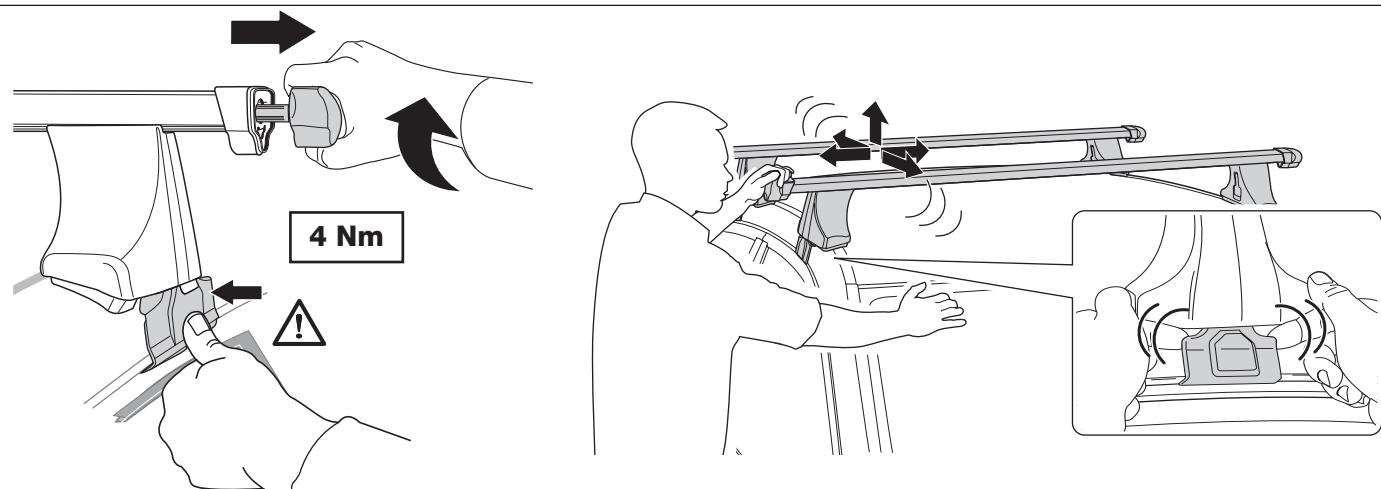
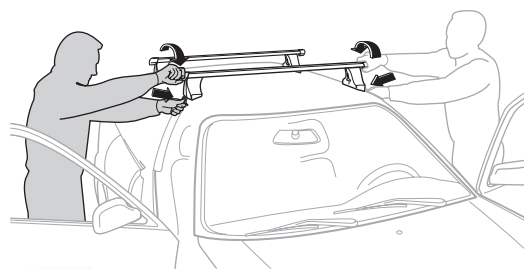

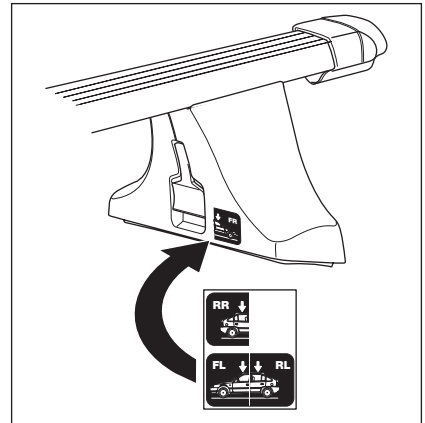
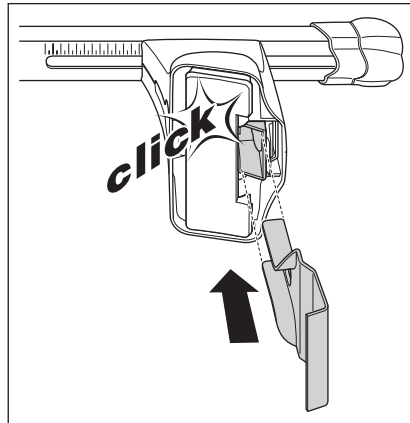
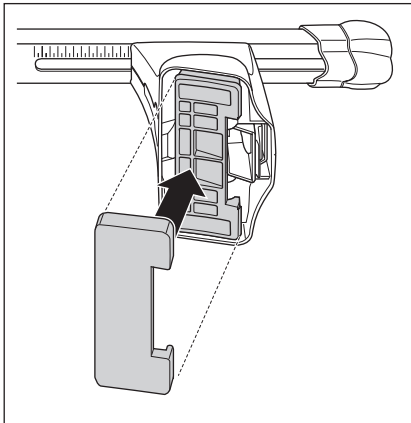

HYUNDAI H-1, 5-dr Van, 08 – (With dual sliding doors)

HYUNDAI iLoad, 5-dr Van, 08 – (With dual sliding doors), (Asia)

HYUNDAI iMax, 5-dr Bus, 08 – (With dual sliding doors), (Asia)

HYUNDAI Starex, 5-dr Van, 08 – (With dual sliding doors)

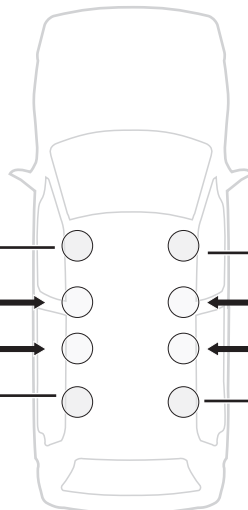
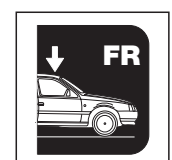
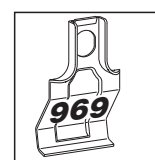
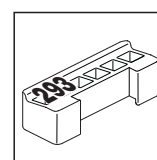
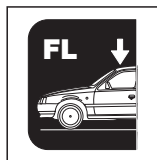
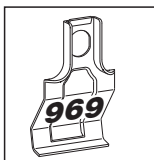
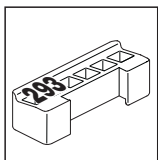

Kit 1475

Kit 1475

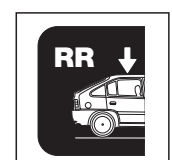
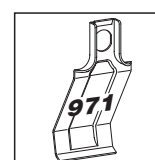
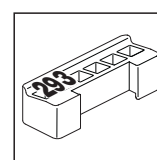
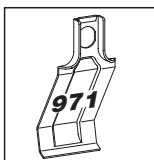
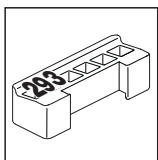

3

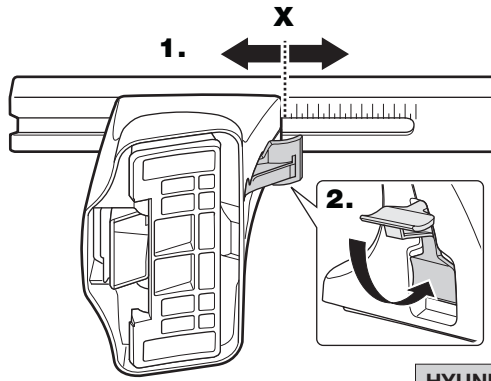
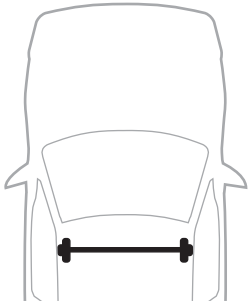

	X
HYUNDAI H1 , 5-dr Van, 08 – (With dual sliding doors)	59,5
HYUNDAI iLoad , 5-dr Van, 08 – (With dual sliding doors), (Asia)	59,5
HYUNDAI iMax , 5-dr Bus, 08 – (With dual sliding doors), (Asia)	59,5
HYUNDAI Starex , 5-dr Van, 08 – (With dual sliding doors)	59,5

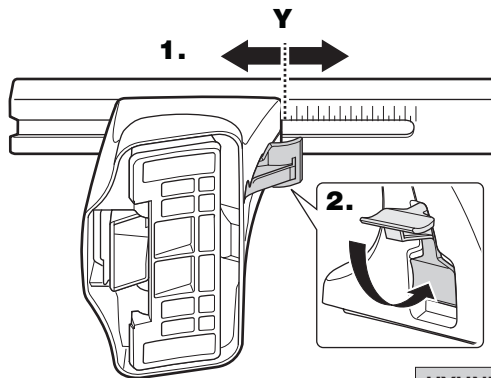
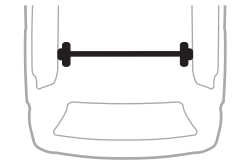

	Y
HYUNDAI H1 , 5-dr Van, 08 – (With dual sliding doors)	55,5
HYUNDAI iLoad , 5-dr Van, 08 – (With dual sliding doors), (Asia)	55,5
HYUNDAI iMax , 5-dr Bus, 08 – (With dual sliding doors), (Asia)	55,5
HYUNDAI Starex , 5-dr Van, 08 – (With dual sliding doors)	55,5

4

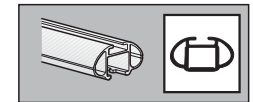
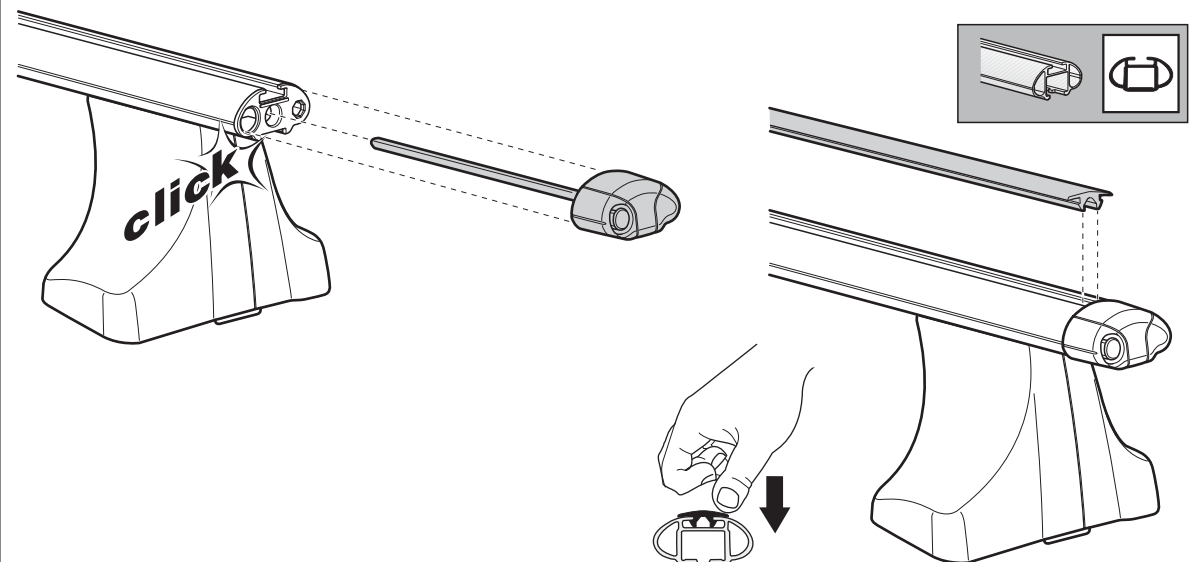
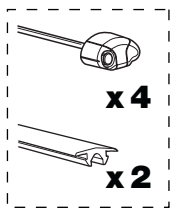
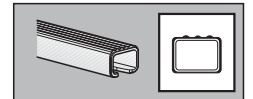
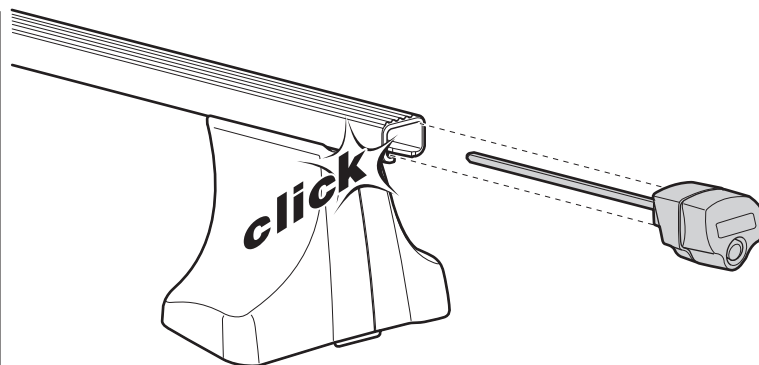
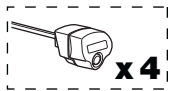

2

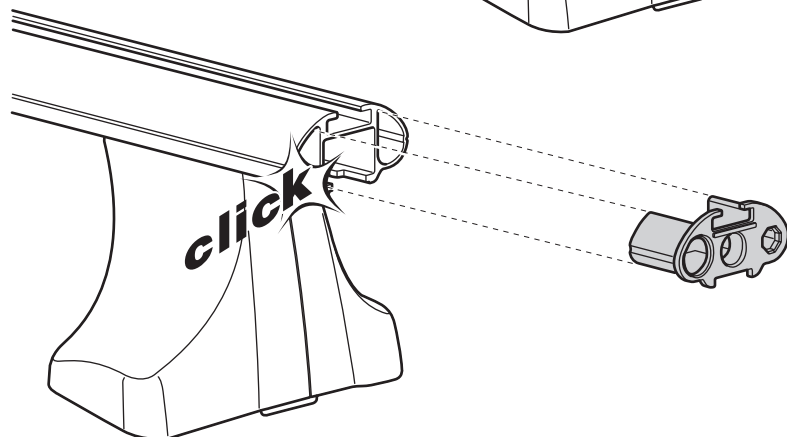
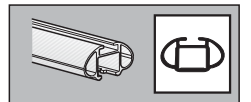
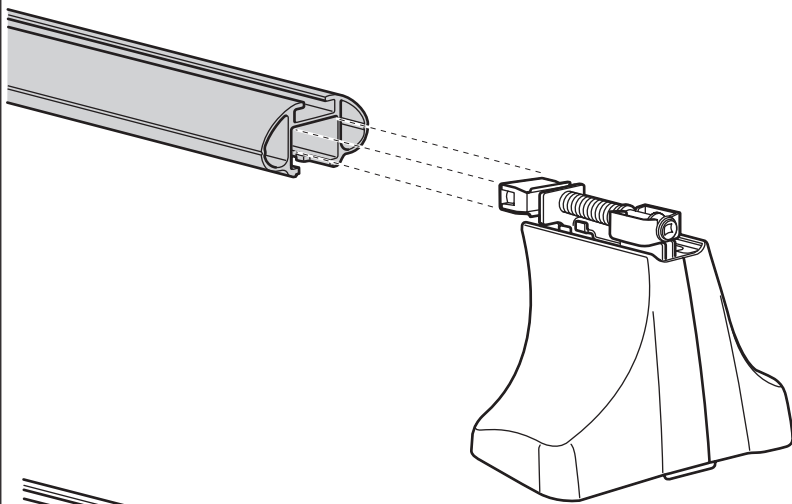
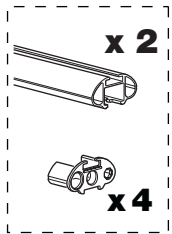
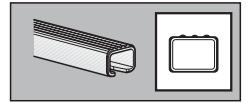
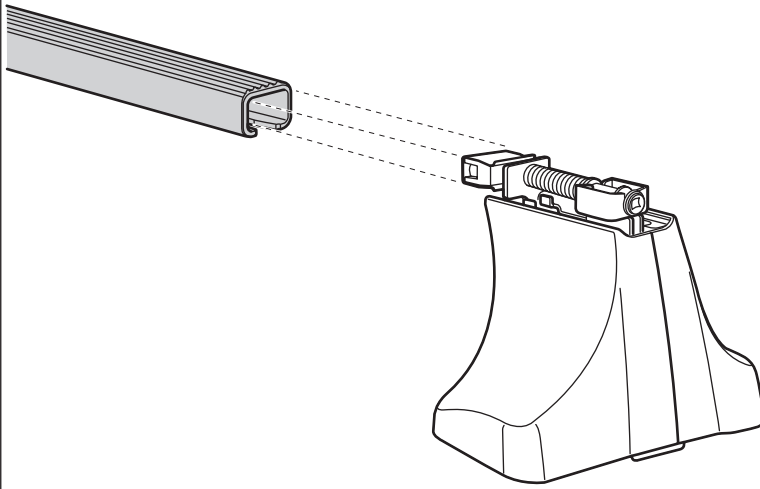
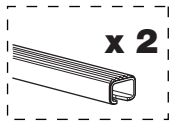
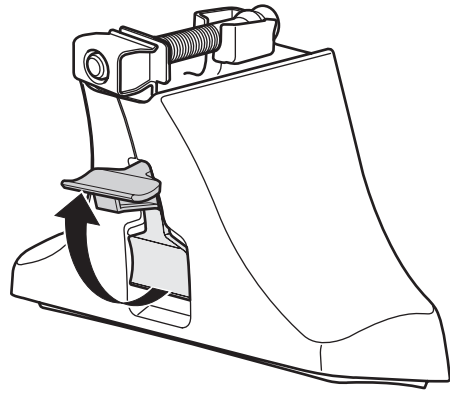
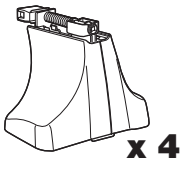

THULE
SWEDEN

S Säkerhetsföreskrifter
GB Safety regulations
D Sicherheits-Vorschriften
F Instructions obligatoires
NL Veiligheidsvoorschriften
FIN Turvatoimivälittelet
E Reglas de seguridad
I Norme di sicurezza
CZ Pokyny na montáž
PL Wykazy bezpieczeństwa
PT Normas de segurança
GR Αρχειοτυπία Απαιτήσεων
TR Güvenlik Kuralları
HU Biztonsági utasítások
RU Инструкция по безопасности
HR Pravila sigurnosti
EST Ohutusjuhised
LIT Saugumo taisyklės
LAT Drošības noteikumi
SLK Varnostni predpisi
KOR 안전 주의 사항
THAI มาตรการความปลอดภัย
CHN 安全注意事项

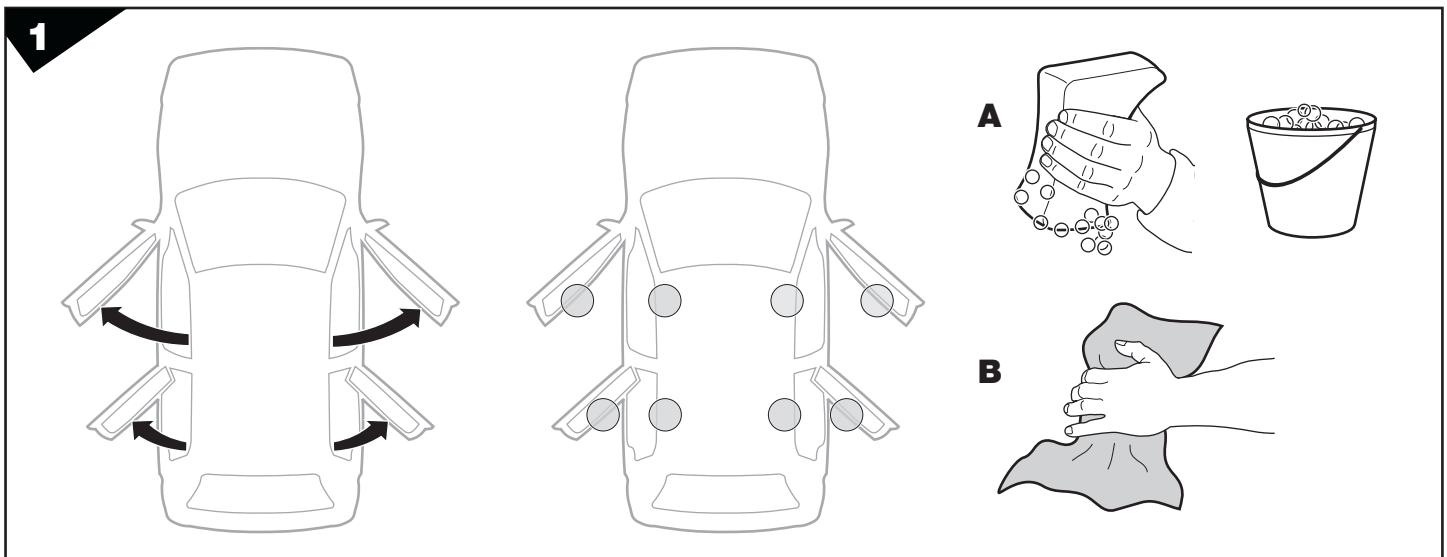
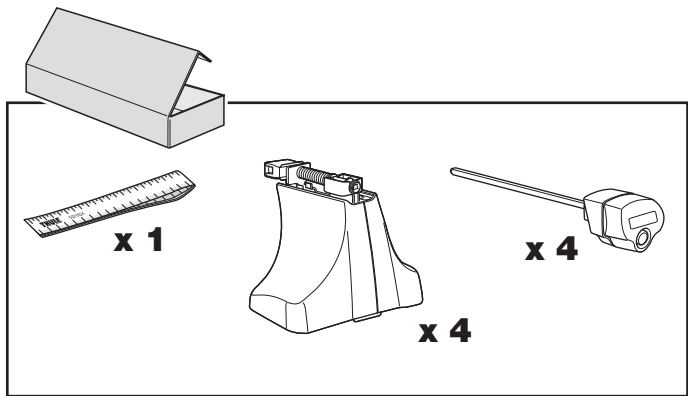
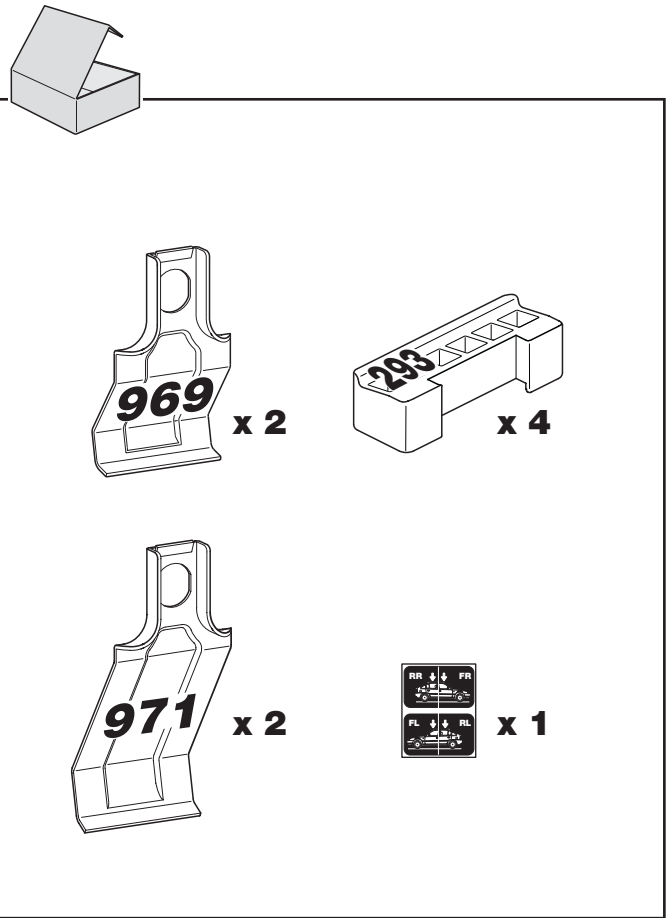
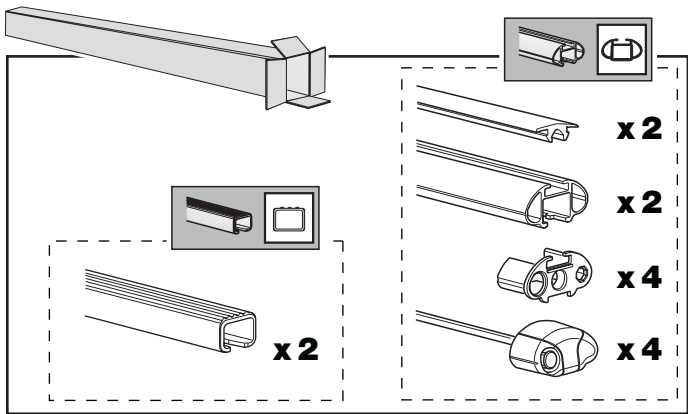
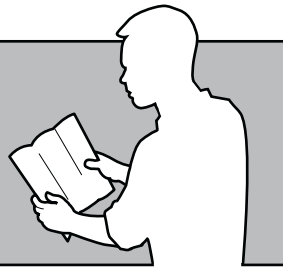
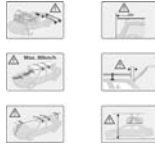

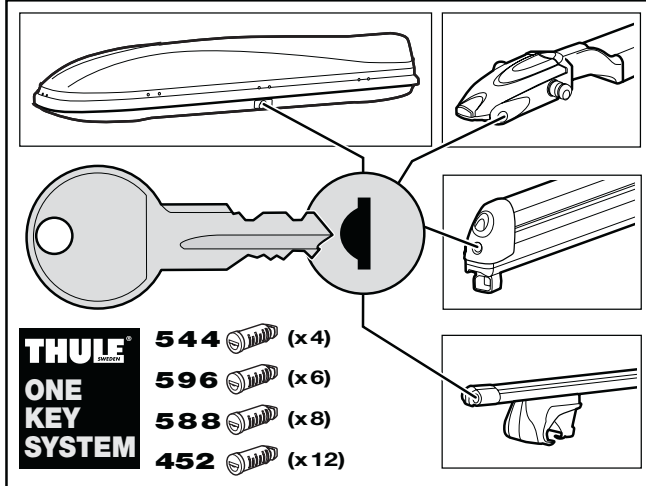
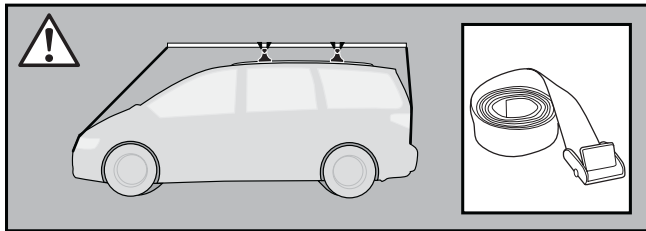
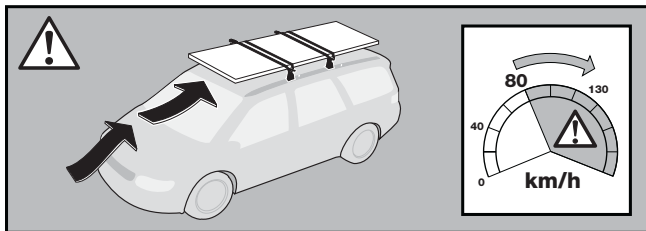
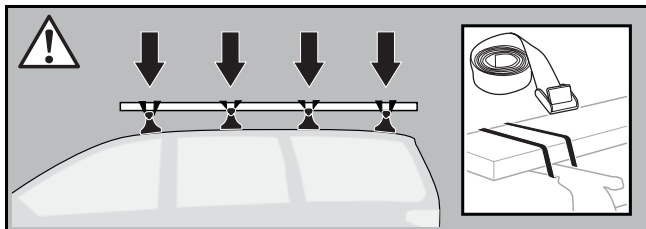
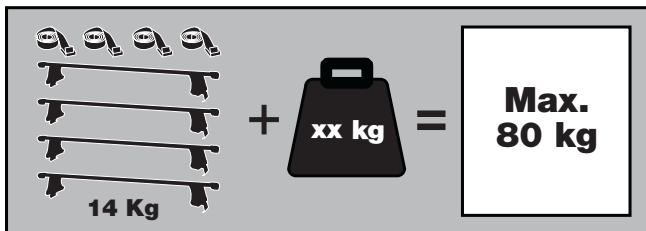
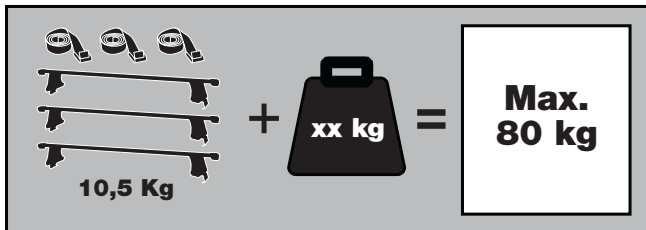
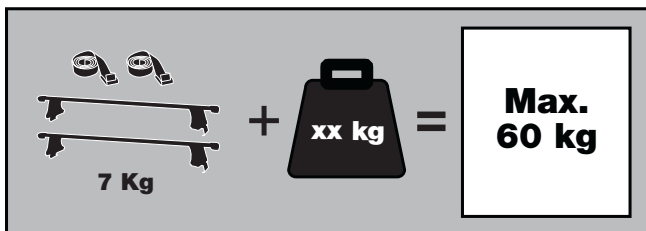

THULE®

SWEDEN

- GB Fitting instructions
- D Montageanleitung
- F Instructions de montage
- NL Montage-instructies
- I Istruzioni per il montaggio
- E Instrucciones de montaje
- PT Instruções de Montagem
- S Monteringsanvisning
- FIN Asennusohje
- EST Paigaldusjuhend
- LAT Stiprināšanas instrukcija
- LIT Pritvirtinimo instrukcijos
- PL Instrukcja montażu
- RU Инструкции по установке
- CZ Návod na montáž
- SK Návod na montáž
- SLO Navodila za pritrjevanje
- HR Uputa za sastavljanje
- HU A felszerelés módja
- GR Οδηγίες συναρμολόγησης
- TR Montaj talimatları
- 中文 安装说明
- 日本語 取扱(取付)説明書
- 한국어 장착 지침
- ไทย คำแนะนำการติดตั้ง

- HYUNDAI H-1, 5-dr Van, 08 – (With dual sliding doors)*
- HYUNDAI iLoad, 5-dr Van, 08 – (With dual sliding doors), (Asia)*
- HYUNDAI iMax, 5-dr Bus, 08 – (With dual sliding doors), (Asia)*
- HYUNDAI Starex, 5-dr Van, 08 – (With dual sliding doors)*

RAPID SYSTEM

Kit 1469



Follow me...

THULE®

SWEDEN

Box 69, 330 33 Hillerstorp, SWEDEN
www.thule.com